

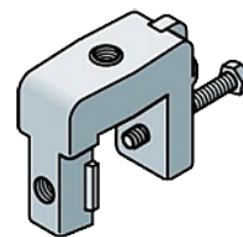

RSB Cleat

Product Description

Cleat for RSB Clip



Features/Benefits

Technical Specifications

Product Line	Coaxial Cable Accessories Elliptical Waveguide Accessories
Product Type	Hanger
Hanger Type	RSB Cleat
Installation Hardware Type	RSB Cleat
Cable Type	Coaxial Foam Dielectric
Number of Cable / Waveguide Runs	1
Angle member adapter clamping range mm (in)	1 / 25 (0.039 / 0.9)
Angle member adpter threads	2x M8
Material	Cleat: Aluminium Screw: Stainless Steel
Installation Temperature, °C(°F)	-50 to 85 (-58 to 185)
Operation Temperature, °C(°F)	-50 to 85 (-58 to 185)
Storage Temperature, °C(°F)	-50 to 85 (-58 to 185)
Package Quantity	10

Notes

Other Documentation

