

Ninigi

D A T A S H E E T

NS39 PLUGS SERIES

Specification:

- 1) Voltage Rating: 250 V AC/DC
- 2) Current Rating: 5A AC/DC
- 3) Temperature Range: -25°C ~ +85°C
- 4) Contact Resistance: 10 mohms max.
- 5) Insulation Resistance: 1000 Mohms min.
- 6) Dielectric Withstanding Voltage: 1500 V AC/DC/Minute
- 7) Material: Nylon 66, UL94V-0

Series No.	No. of ways	A	B
NS39-G2	2	3.96	8.04
NS39-G3	3	7.92	12.10
NS39-G4	4	11.88	15.96
NS39-G5	5	15.84	20.00
NS39-G6	6	19.80	23.90

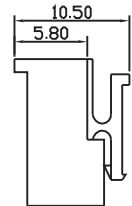
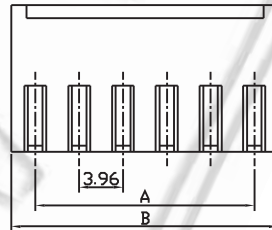
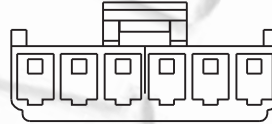
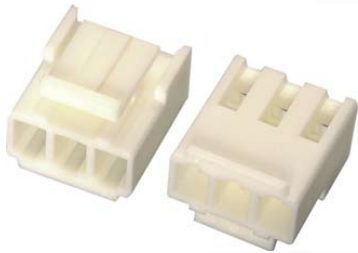

NS39-Txx

Material:

- None - phosphor bronze
- B - brass

Contact Plating:

- none - tin
- S - selective gold
- G - gold flash

Terminal for NS39 Connectors

