

This document is the property of Amphenol Corporation and is delivered on the express condition that it is not to be disclosed, reproduced or used, in whole or in part, for the manufacture or sale by anyone other than Amphenol Corporation without its prior consent, and that no right is granted to disclose or to use any information in this document.

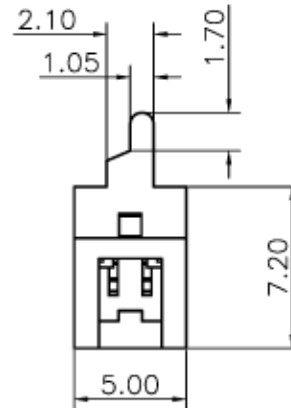
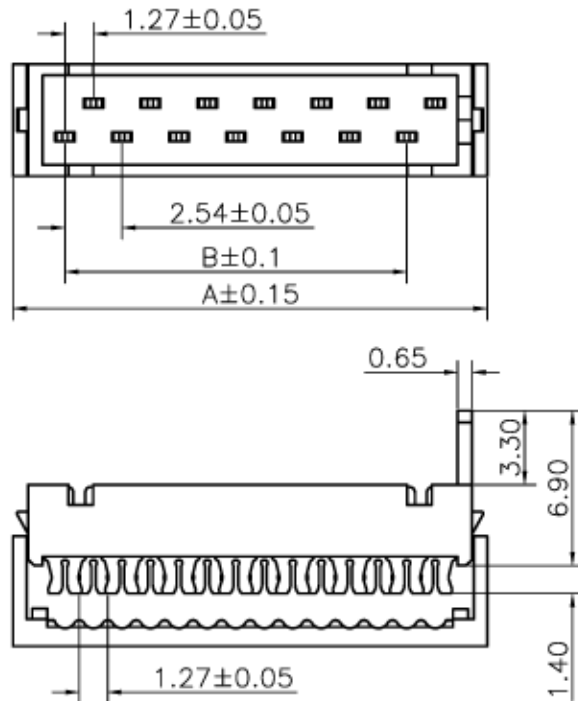
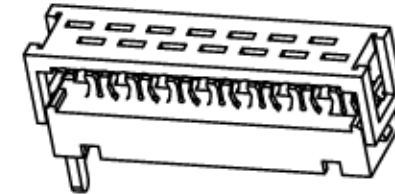

Specifications:

- Current Rating:1.0A AC/DC
- Voltage Rating:30V AC/DC
- Contact Resistance:20m ohm. Max.
- Insulation Resistance:1000M ohm. Min.
- Withstanding Voltage:500V AC For One Minute
- Operating Temperature Range:-40°C ~ +105°C
- Material and Finish
- Insulator:High Temp. Plastic (UL94V-0)
- Contact:Copper Alloy
- Finish:Tin Plated

How to Order

TMM-X-X-XX-X

- Type**
 - 1-IDC Male
 - 2-IDC Plug
 - 3-DIP Male Straight
 - 4-DIP Female Straight
 - 5-DIP Female R/A
 - 6-SMT Female Straight
- Locking System**
 - 0-without lock
 - L-with lock
- Packaging**
 - 1 - Tape & Reel
 - 2 - Tube
 - 3 - Bag
- Number of Positions**
 - 04, 06, 08, 10, 12,
 - 14, 16, 18 or 20

Circuits	Dimension		Circuits	Dimension	
	A	B		A	B
4	8.45	2.54	16	23.69	17.78
6	10.99	5.08	18	26.23	20.32
8	13.53	7.62	20	28.77	22.86
10	16.07	10.16	22	31.31	25.40
12	18.61	12.70	24	33.85	27.94
14	21.15	15.24	26	36.39	30.48

TOLERANCE (mm)	APPROVALS	DATE	TITLE	AMPHENOL Amphenol European Design Center	
X. ±0.3	DESIGN Stephane	2008/04/22	Micro Match IDC type Male	Scale N.A.	Sheet 1 of 1
XX ±0.1	CHECKED Rob K.	2008/04/23			
XX ±0.05	APPROVED Rob K.	2008/04/23			
UNLESS OTHERWISE SPECIFIED	UNIT MM	SIZE A4	DRAWING N° TMM-1-0-XX-X	REV. A	