

Tous droits strictement réservés. Reproduction ou communication a des tiers interdite sous quelque forme que ce soit sans autorisation écrite du propriétaire. Propriété de c FCI. Droits de reproduction FCI.

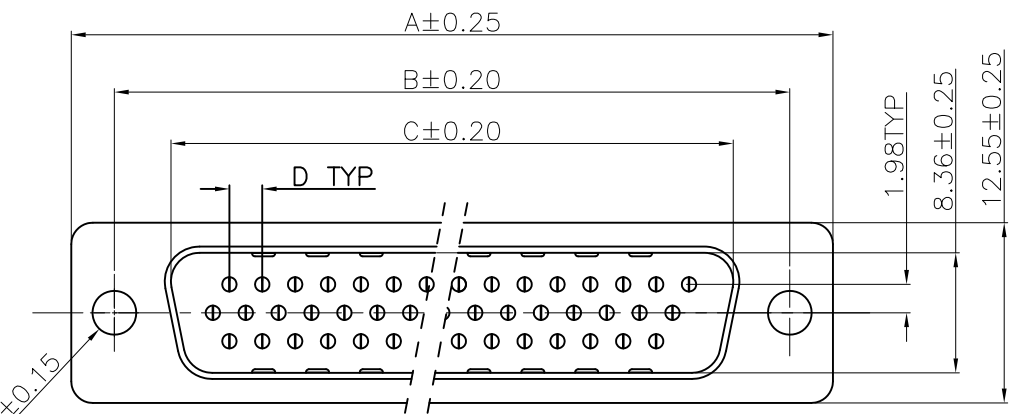

All rights strictly reserved. Reproduction or issue to third parties in any form whatever is not permitted without written authority from the proprietor. Property of FCI. Copyright FCI.



FOR 26/44/62P

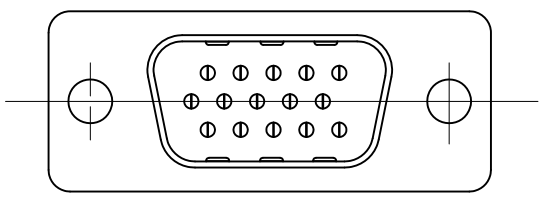
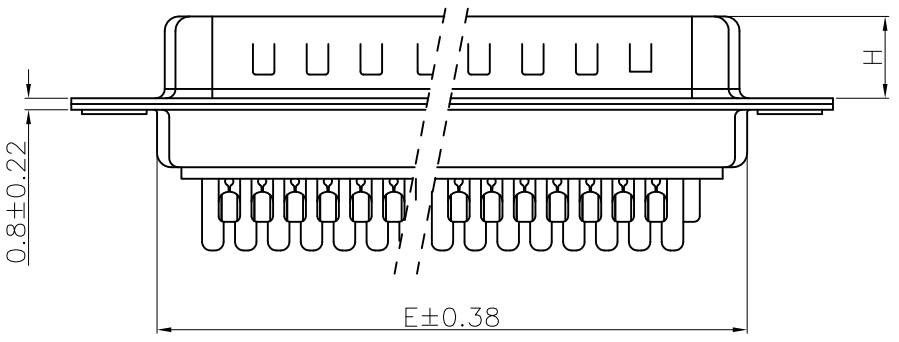

FOR 15P

POS.	PART NO.	A	B	C	D	E	H
15	10090769-P15*ALF	30.81	24.99	16.92	2.29	19.10	5.90 <sup>+0.25</sup> <sub>0</sub>
26	10090769-P26*ALF	39.24	33.32	25.25	2.29	27.75	5.90 <sup>+0.25</sup> <sub>0</sub>
44	10090769-P44*ALF	53.04	47.04	38.96	2.29	41.30	5.70 <sup>+0.25</sup> <sub>0</sub>
62	10090769-P62*ALF	69.32	63.50	55.42	2.41	57.40	5.70 <sup>+0.25</sup> <sub>0</sub>

REMARK:

1. CHARACTERISTICS:
- RATED VOLTAGE: 250V
  - RATED CURRENT: 2.5AMP
  - CONTACT RESISTANCE: 25mohms MAX. INITIAL, 40mohms MAX. AFTER.
  - INSULATION RESISTANCE: 5000Mohms MIN. at 500V DC
  - DIELECTRIC STRENGTH: 750VRMS
  - OPERATING TEMPERATURE RANGE: -55C° ~105C°
  - INSERTION/EXTRACTION FORCE PER CONTACT: 5N Max. /0.2N Min.
  - MATING/UNMATING CYCLES: 50MATINGS MIN FOR GOLD-FLASH, 500MATINGS MIN FOR 30u" GOLD.

2. MATERIAL:

- INSULATORS: THERMOPLASTIC G. F(UL94V-0) BLACK
- CONTACTS: COPPER ALLOY, GOLD(G/F or 30u") TOP OVER CONTACT AREA, 100u" Min MATTE TIN TOP OVER SOLDER AREA, 50u" Min NICKEL UNDER PLATE.
- SHELL: CARBON STEEL, 100u" Min NICKEL TOP OVER, 50u" Min COPPER UNDER PLATE.

3. PART NUMBER DESCRIPTION: 10090769-P XX X X LF

- SERIES NO.
- TYPE: P: PIN (MALE)
- NUMBER OF CONTACTS: 15: 15-PIN, 26: 26-PIN, 44: 44-PIN, 62: 62-PIN
- LF: ROHS COMPLIANT
- FLANGE MOUNTING OPTION A: STANDARD HOLE
- CONTACT FINISH: 4:GOLD FLASH, 6:30u" GOLD

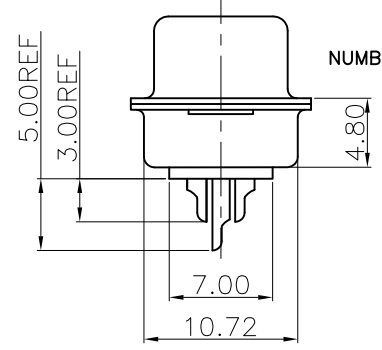

mat'l. code				tolerances unless otherwise specified				CUSTOMER COPY		FCI		www.fciconnect.com	
ltr	ecn no	dr	date	linear	.X ± 0.38		projection	title		H/D D-SUB MALE SOLDER BUCKET		code TWN	
A	T09-1156	J.H	12/10/09		.XX ± 0.25			MM					
					.XXX ± 0.10			scale					
				angles	0° ±2°			1:1		A4		10090769	
				dr	JASON HSU	12/10/09		product family		D-SUB		code	
				enr	JASON HSU	12/10/09		size		dwg no		sheet	
				chr	GARY HSIEH	12/10/09						1 of 2	
				appd	JOSEPH HSIA	12/10/09							
sheet index	revision sheet	A	A										
		1	2										

Tous droits strictement réservés. Reproduction ou communication a des tiers interdite sous quelque forme que ce soit sans autorisation écrite du propriétaire. Propriete de c FCI. Droite de reproduction FCI.



All rights strictly reserved. Reproduction or issue to third parties in any form whatever is not permitted without written authority from the proprietor. Property of FCI. Copyright FCI.

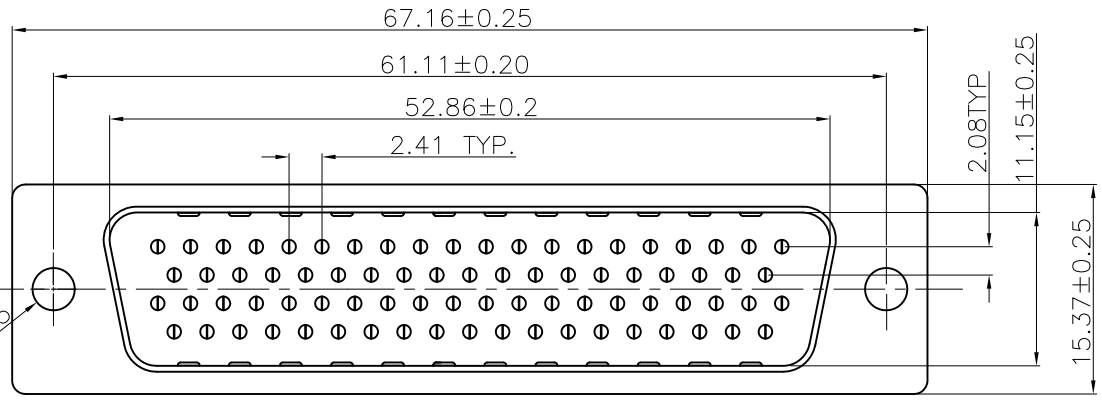

REMARK:

1. CHARACTERISTICS:

RATED VOLTAGE: 250V  
 RATED CURRENT: 2.5AMP  
 CONTACT RESISTANCE: 35mohms MAX. INITIAL,  
 50mohms MAX. AFTER.  
 INSULATION RESISTANCE: 5000Mohms MIN. at 500V DC  
 DIELECTRIC STRENGTH: 750VRMS  
 OPERATING TEMPERATURE RANGE: -55°C ~105°C  
 INSERTION/EXTRACTION FORCE PER CONTACT: 5N Max. /0.2N Min.  
 MATING/UNMATING CYCLES: 50MATINGS MIN FOR GOLD-FLASH  
 500MATINGS MIN FOR 30u" GOLD.

2. MATERIAL:

INSULATORS: THERMOPLASTIC G.F(UL94V-0) BLACK  
 CONTACTS: COPPER ALLOY, GOLD(G/F or 30U") TOP OVER CONTACT  
 AREA, 100u" Min MATTE TIN TOP OVER SOLDER AREA,  
 50u" Min NICKEL UNDER PLATE.  
 SHELL: CARBON STEEL, 100u" Min NICKEL TOP OVER,  
 50u" Min COPPER UNDER PLATE.

3. PART NUMBER DESCRIPTION: 10090769-P XX X X LF

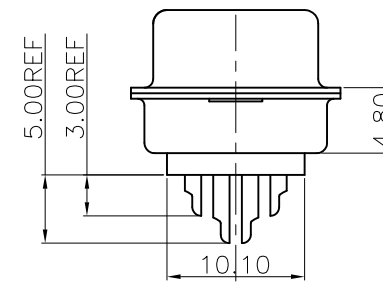
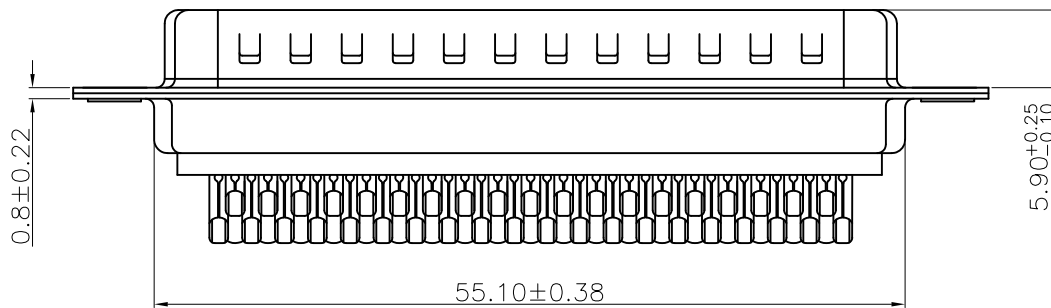
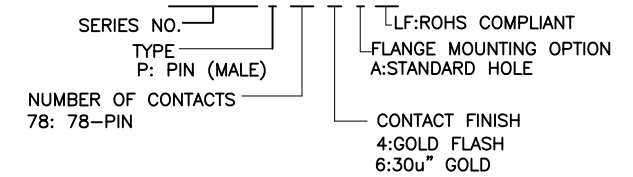

PART NO.: 10090769-P78\*ALF

mat'l. code				tolerances unless otherwise specified				CUSTOMER COPY		FCI www.fciconnect.com	
ltr	ecn no	dr	date	linear	.X ± 0.38		projection	title			
A					.XX ± 0.25			H/D D-SUB 78P MALE SOLDER BUCKET			
					.XXX ± 0.10						
				angles	0° ±2'		MM		product family D-SUB		code
				dr	JASON HSU	12/10/09	scale		size dwg no		TWN
				enr	JASON HSU	12/10/09	1:1		A4		10090769
				chr	GARY HSIEH	12/10/09					sheet
				appd	JOSEPH HSIA	12/10/09					2 of 2
sheet index	revision sheet										