

| AWG: | MAX. INSULATION |
|-------|-----------------|
| 20-24 | .073/(1.85) |
| 26-30 | .050/(1.27) |

| ITEM NUMBER | PLATING OPTION | WIRE SIZE | ASSEMBLY OPTION | "A" ±.016 (±0.41) | "C" ±.012 (±0.30) | "D" ±.005 (±0.13) | "E" ±.016 (±0.41) | "G" ±.005 (±0.13) | "H" ±.012 (±0.30) |
|-------------|----------------|-----------|-----------------|-------------------------|-------------------------|-------------------------|-------------------------|-------------------------|-------------------------|
| 43031-0001 | A | 20-24 | CHAIN | .090/(2.29) | .100/(2.54) | .030/(0.76) R. | .075/(1.91) | .025/(0.64) R. | .082/(2.08) |
| 43031-0002 | B | 20-24 | CHAIN | .090/(2.29) | .100/(2.54) | .030/(0.76) R. | .075/(1.91) | .025/(0.64) R. | .082/(2.08) |
| 43031-0003 | C | 20-24 | CHAIN | .090/(2.29) | .100/(2.54) | .030/(0.76) R. | .075/(1.91) | .025/(0.64) R. | .082/(2.08) |
| 43031-0004 | A | 26-30 | CHAIN | .075/(1.91) | .083/(2.10) | .025/(0.64) R. | .058/(1.47) | .020/(0.51) R. | .065/(1.65) |
| 43031-0005 | B | 26-30 | CHAIN | .075/(1.91) | .083/(2.10) | .025/(0.64) R. | .058/(1.47) | .020/(0.51) R. | .065/(1.65) |
| 43031-0006 | C | 26-30 | CHAIN | .075/(1.91) | .083/(2.10) | .025/(0.64) R. | .058/(1.47) | .020/(0.51) R. | .065/(1.65) |
| 43031-0007 | A | 20-24 | LOOSE | .090/(2.29) | .100/(2.54) | .030/(0.76) R. | .075/(1.91) | .025/(0.64) R. | .082/(2.08) |
| 43031-0008 | B | 20-24 | LOOSE | .090/(2.29) | .100/(2.54) | .030/(0.76) R. | .075/(1.91) | .025/(0.64) R. | .082/(2.08) |
| 43031-0009 | C | 20-24 | LOOSE | .090/(2.29) | .100/(2.54) | .030/(0.76) R. | .075/(1.91) | .025/(0.64) R. | .082/(2.08) |
| 43031-0010 | A | 26-30 | LOOSE | .075/(1.91) | .083/(2.10) | .025/(0.64) R. | .058/(1.47) | .020/(0.51) R. | .065/(1.65) |
| 43031-0011 | B | 26-30 | LOOSE | .075/(1.91) | .083/(2.10) | .025/(0.64) R. | .058/(1.47) | .020/(0.51) R. | .065/(1.65) |
| 43031-0012 | C | 26-30 | LOOSE | .075/(1.91) | .083/(2.10) | .025/(0.64) R. | .058/(1.47) | .020/(0.51) R. | .065/(1.65) |

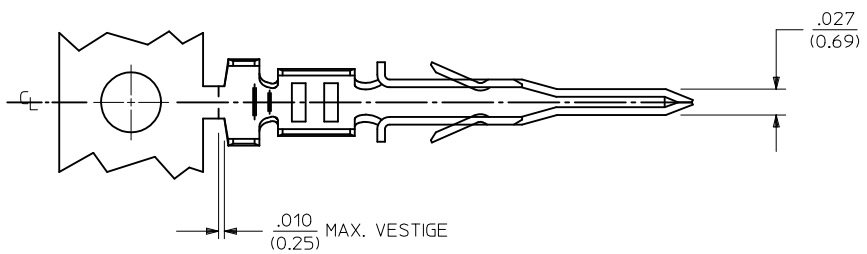

NOTES:

- 1) MATERIAL : PHOSPHOR BRONZE ALLOY
- 2) TERMINAL PLATING:
 A = HOT TIN DIP: .000040/(0.00102) MIN.
 B = .000015/(0.00038) MIN. SELECT GOLD .000100/(0.002543) MIN. SELECT TIN OVER .000050/(0.00127) MIN. NICKEL
 C = .000030/(0.00076) MIN. SELECT GOLD .000100/(0.002543) MIN. SELECT TIN OVER .000050/(0.00127) MIN. NICKEL
 * MATERIAL NUMBERS WITH SELECT PLATING ARE POST-PLATED AFTER FORMING.
- 3) PRODUCT SPECIFICATION : PS-43045, PS-43650, PS-44300-001
- 4) PACKAGING SPECIFICATION: PK-43031-001 (REEL), PK-43030-003 (LOOSE).
- 5) TERMINAL FOR USE IN MICRO FIT PLUG 43020-****, 43640-****, AND 44300-****.
- 6) FOR TERMINAL ORIENTATION IN PLUG SEE DRAWING SDA-43020-**** OR SD-43640-****.
- 7) THIS TERMINAL IS DESIGNED IN METRIC.
- 8) THE PRIMARY SHIPPING CARTON WILL BE LABELED "COMPLIANT TO RoHS DIRECTIVE 2002/95/EC AND ELV ANNEX II OF DIRECTIVE 2000/53/EC." CARTONS WITHOUT THIS LABEL MAY CONTAIN PRODUCT WITH TIN/LEAD IN THE PC TAIL AREA.
- 9) SOME GOLD MAY BE PRESENT ON INSIDE SURFACE.

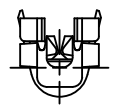
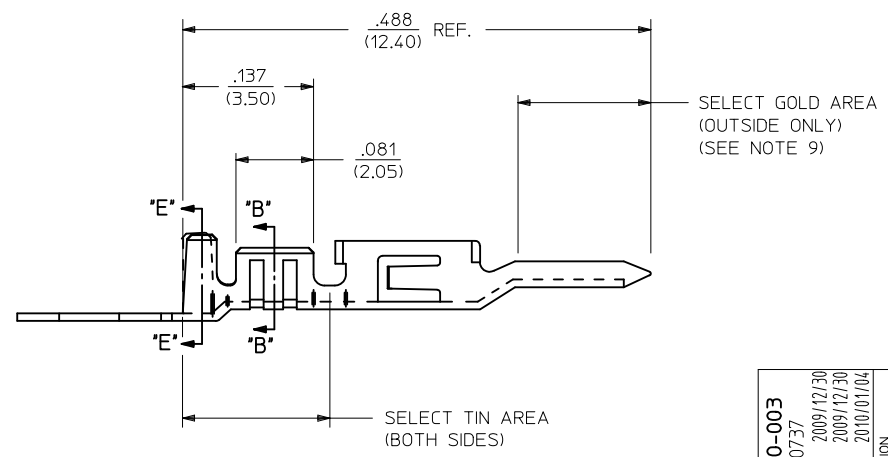

| | | | | | |
|---|-------------------------------|--|---|--|------------------------|
| ADD PK-43030-003 EC NO: UCP2010-0737 DRWN:SSOUSEK 2009/12/30 CHKD:SSOUSEK 2009/12/30 APPR:FSMITH 2010/01/04 | QUALITY SYMBOLS ▽=0 ▽=0 | GENERAL TOLERANCES (UNLESS SPECIFIED) mm INCH 4 PLACES ± --- ± --- 3 PLACES ± --- ±.014 2 PLACES ± 0.25 ±.010 1 PLACE ± 0.35 ± --- ANGULAR ±1/2° | DIMENSION STYLE IN/MM DRAWN BY DATE MUELLER 2002/08/13 CHECKED BY DATE MUELLER 2002/08/13 APPROVED BY DATE MARGULIS 2002/08/13 | SCALE --- DESIGN UNITS METRIC | THIRD ANGLE PROJECTION |
| | MICRO-FIT (3.0) MALE TERMINAL | | | | |
| | MOLEX INCORPORATED | | | | |
| | SEE CHART SD-43031-**** | | | | |
| DRAFT WHERE APPLICABLE MUST REMAIN WITHIN DIMENSIONS | | MATERIAL NO. DOCUMENT NO. SHEET NO. | | | 1 OF 1 |
| THIS DRAWING CONTAINS INFORMATION THAT IS PROPRIETARY TO MOLEX INCORPORATED AND SHOULD NOT BE USED WITHOUT WRITTEN PERMISSION | | | | | |