

THIS DRAWING IS UNPUBLISHED.
 VERTRAULICHE UNVERÖFFENTLICHTE ZEICHNUNG
 © COPYRIGHT - By -
 RELEASED FOR PUBLICATION
 FREI FUER VERÖFFENTLICHUNG
 ALL RIGHTS RESERVED.
 ALLE RECHTE VORBEHALTEN

MATED WITH:
 PASSEND ZU:
 -

LOC	DIST	REVISIONS ÄNDERUNGEN		
AI	-	P	LTR	DESCRIPTION BESCHREIBUNG
PROJEKT NR.:		Z1	REVISED PER ECO-11-005150	DATE 21MAR11
				DWN RK
				APVD HMR

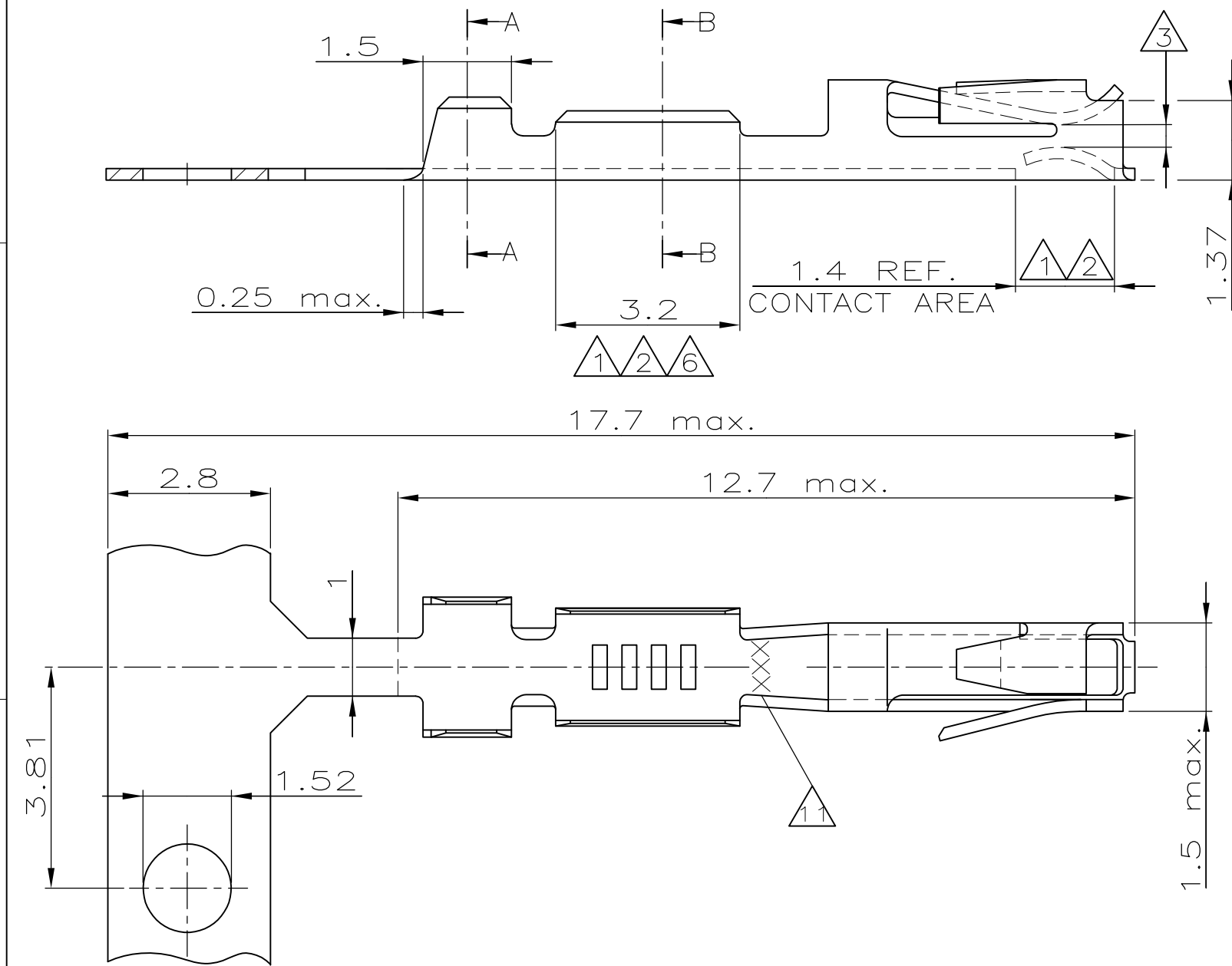

NOTES:

- ① UNDERCOATING: 0,8µm NICKEL OVERALL.
CONTACT AREA: 0,8µm GOLD.
CRIMP AREA : GOLDFLASH
- ② UNDERCOATING: 0,8µm NICKEL OVERALL.
CONTACT AREA: 1,25µm GOLD.
CRIMP AREA : GOLDFLASH
- ③ SUITABLE FOR 0,64x0,64 POST.
- ⑥ UNDERCOATING: 0,8µm NICKEL OVERALL.
CONTACT AREA: 0,4µm GOLD.
CRIMP AREA : GOLDFLASH
- ⑦ ADVANCED PROD. NRS. FOR DIN 41612 PART 5 SPEC.
- ⑧ PLATING : 2,0 µm TIN OVERALL.
- ⑨ REVERSE REELED FOR USE WITH MINI APPLICATOR.
- ⑩ STANDARD REELED FOR USE WITH STANDARD APPLICATOR.
- ⑪ TRADE MARK

WIRE RANGE :
 20 - 24 (26) AWG
 INSULATION RANGE :
 1,40 MAX DIA.

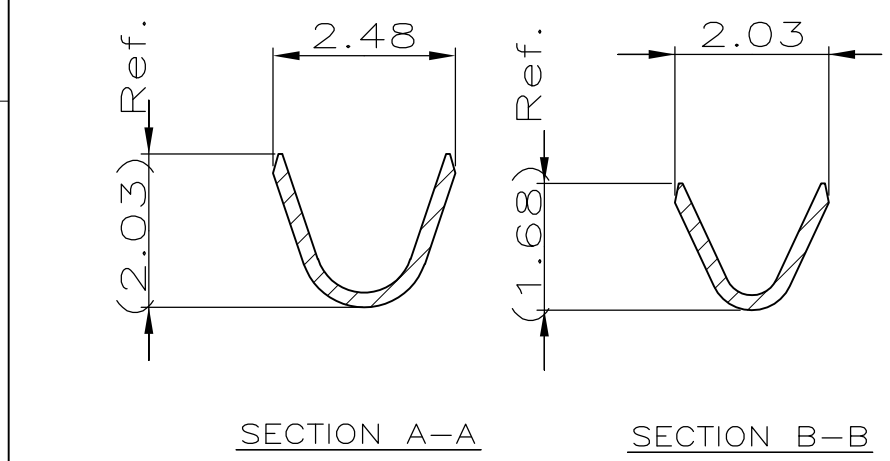

SUPERSEDED BY 166500-2

166722-1	①	PHOSPHORBRONZE	1-166500-2	⑩	Z
166722-6	⑧		1-166500-1	⑩	Z
166722-6	⑧		166500-9	⑨	Z
⑦ 166722-4	⑥		166500-7	⑨	W
166722-2	②		166500-4	⑨	Z
166722-1	①		166500-2	⑨	Z
LOOSE PIECE NUMBER	PLATING		MATERIAL	STRIPNUMBER	REV.

THIS DRAWING IS A CONTROLLED DOCUMENT.
 DIESE ZEICHNUNG IST EIN KONTROLLIERTES DOKUMENT.

DIMENSIONS: DIMENSIONEN: mm
 TOLERANCES UNLESS OTHERWISE SPECIFIED: ALLGEMEINTOLERANZEN
 n. ISO 8015
 n. ISO 2768 - mH
 0 PLC ± -
 1 PLC ± -
 2 PLC ± -
 3 PLC ± -
 4 PLC ± -
 ANGLES / WINKEL ± 1°

MATERIAL: -
 FINISH / OBERFLÄCHE / FARBE: -

DWN: M.Pfeilschiffer 18-JUL-00
 CHK: V. Huhn 18-JUL-00
 APVD: -
 PRODUCT SPEC: -
 APPLICATION SPEC: -
 VERARBEITUNGSSPEZ.: -

WEIGHT: -
 GEWICHT: -

CUSTOMER DRAWING / KUNDENZEICHNUNG

SCALE: 0:1
 SHEET: 1 OF 1
 REV: Z1

STE TE Connectivity
 STANDARD TANDEM SPRING RECEPTACLE

SIZE: A3
 CAGE CODE: 00779
 DRAWING NO: C-166500
 RESTRICTED TO NUR FUER: -