

## Konektory krimpovací PAW, PXH, RM=2,50mm

### PAW7600, PAWR7600 a PXH7000

rozteč pinů:	2.50mm	AC/DC napětí:	250V
počet pinů:	2 až 20	AC/DC proud:	2A
prac. teplota:	-25+85°C	zkušební napětí:	1000V AC / 1min
izolační odpor:	>1000MΩ	dop. otvor v DSP	1.0mm
barva:	bílá	průřez vodiče:	AWG22+AWG28
povrch kontaktu:	Sn	vnější Ø izolace [mm]:	1.75 max
odpor kontaktu	20mΩ max		

**Kcr**    **PAW7600** - **05**    **Sn**  
série    typ    počet pinů    materiál pinů

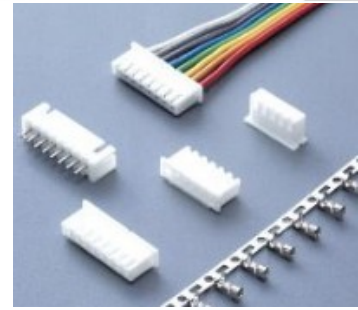

#### Kcr PXH7000-07

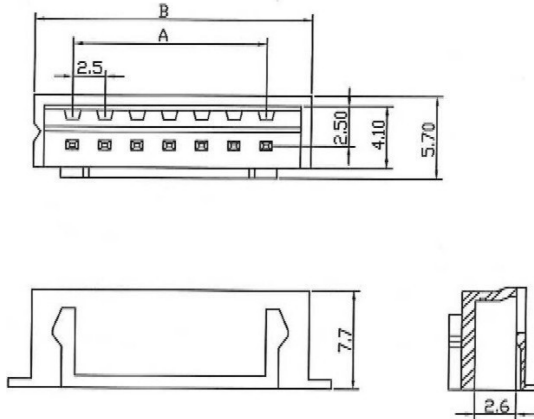

#### Kcr KONTAKT-PXH7000

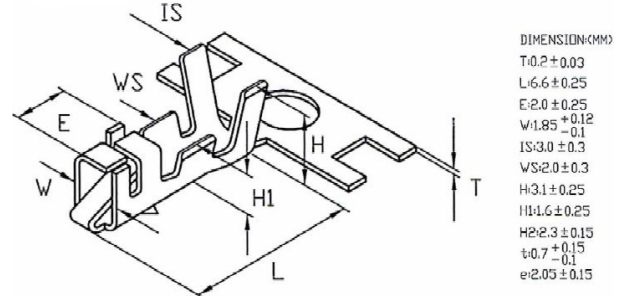

objednáací název zásuvka	počet pinů	A [mm]	B [mm]	kontakt	protikus					
					vidlice - 180°		vidlice - 90°			
					objednáací název	A(mm)	B(mm)	objednáací název	A(mm)	B(mm)
Kcr PXH7000-02	2	2.50	7.30	Kcr KONTAKT-PXH7000 Sn	Kcr PAW7600-02	2.50	7.50	Kcr PAWR7600-02	2.50	7.50
Kcr PXH7000-03	3	5.00	9.80		Kcr PAW7600-03	5.00	10.00	Kcr PAWR7600-03	5.00	10.00
Kcr PXH7000-04	4	7.50	12.30		Kcr PAW7600-04	7.50	12.50	Kcr PAWR7600-04	7.50	12.50
Kcr PXH7000-05	5	10.00	14.80		Kcr PAW7600-05	10.00	15.00	Kcr PAWR7600-05	10.00	15.00
Kcr PXH7000-06	6	12.50	17.30		Kcr PAW7600-06	12.50	17.50	Kcr PAWR7600-06	12.50	17.50
Kcr PXH7000-07	7	15.00	19.80		Kcr PAW7600-07	15.00	20.10	Kcr PAWR7600-07	15.00	20.00
Kcr PXH7000-08	8	17.50	22.30		Kcr PAW7600-08	17.50	22.60	Kcr PAWR7600-08	17.50	22.50
Kcr PXH7000-09	9	20.00	24.80		Kcr PAW7600-09	20.00	25.10	Kcr PAWR7600-09	20.00	25.00
Kcr PXH7000-10	10	22.50	27.30		Kcr PAW7600-10	22.50	27.60	Kcr PAWR7600-10	22.50	27.50
Kcr PXH7000-11	11	25.00	29.80		Kcr PAW7600-11	25.00	30.10	Kcr PAWR7600-11	25.00	30.00
Kcr PXH7000-12	12	27.50	32.30		Kcr PAW7600-12	27.50	32.60	Kcr PAWR7600-12	27.50	32.50
Kcr PXH7000-13	13	30.00	34.80		Kcr PAW7600-13	30.00	35.10	Kcr PAWR7600-13	30.00	35.00
Kcr PXH7000-14	14	32.50	37.30		Kcr PAW7600-14	32.50	37.60	Kcr PAWR7600-14	32.50	37.50
Kcr PXH7000-15	15	35.00	39.80		Kcr PAW7600-15	35.00	40.10	Kcr PAWR7600-15	35.00	40.00
Kcr PXH7000-16	16	37.50	42.30		Kcr PAW7600-16	37.50	42.60	Kcr PAWR7600-16	37.50	42.50
Kcr PXH7000-17	17	40.00	44.80		Kcr PAW7600-17	40.00	45.10	Kcr PAWR7600-17	40.00	45.00
Kcr PXH7000-18	18	42.50	47.30		Kcr PAW7600-18	42.50	47.60	Kcr PAWR7600-18	42.50	47.50
Kcr PXH7000-19	19	45.00	49.80		Kcr PAW7600-19	45.00	50.10	Kcr PAWR7600-19	45.00	50.00
Kcr PXH7000-20	20	47.50	52.30		Kcr PAW7600-20	47.50	52.60	Kcr PAWR7600-20	47.50	52.50

#### Kcr PAW7600-08

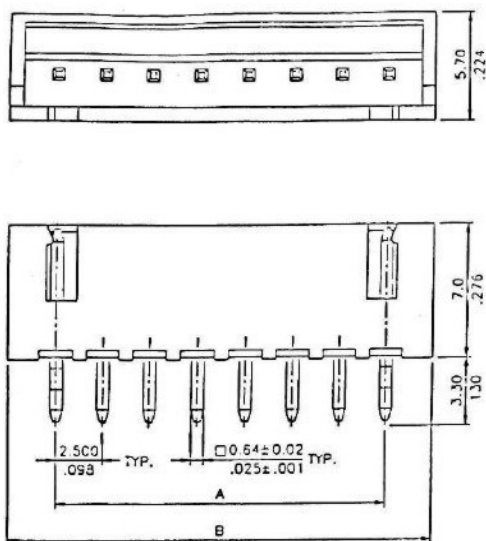

#### Kcr PAWR7600-08

