

## High Density Connectors *High Density Steckverbinder*

## Product Description *Produktbeschreibung*

### High Density D-Sub Connectors

### *High Density D-Sub Steckverbinder*

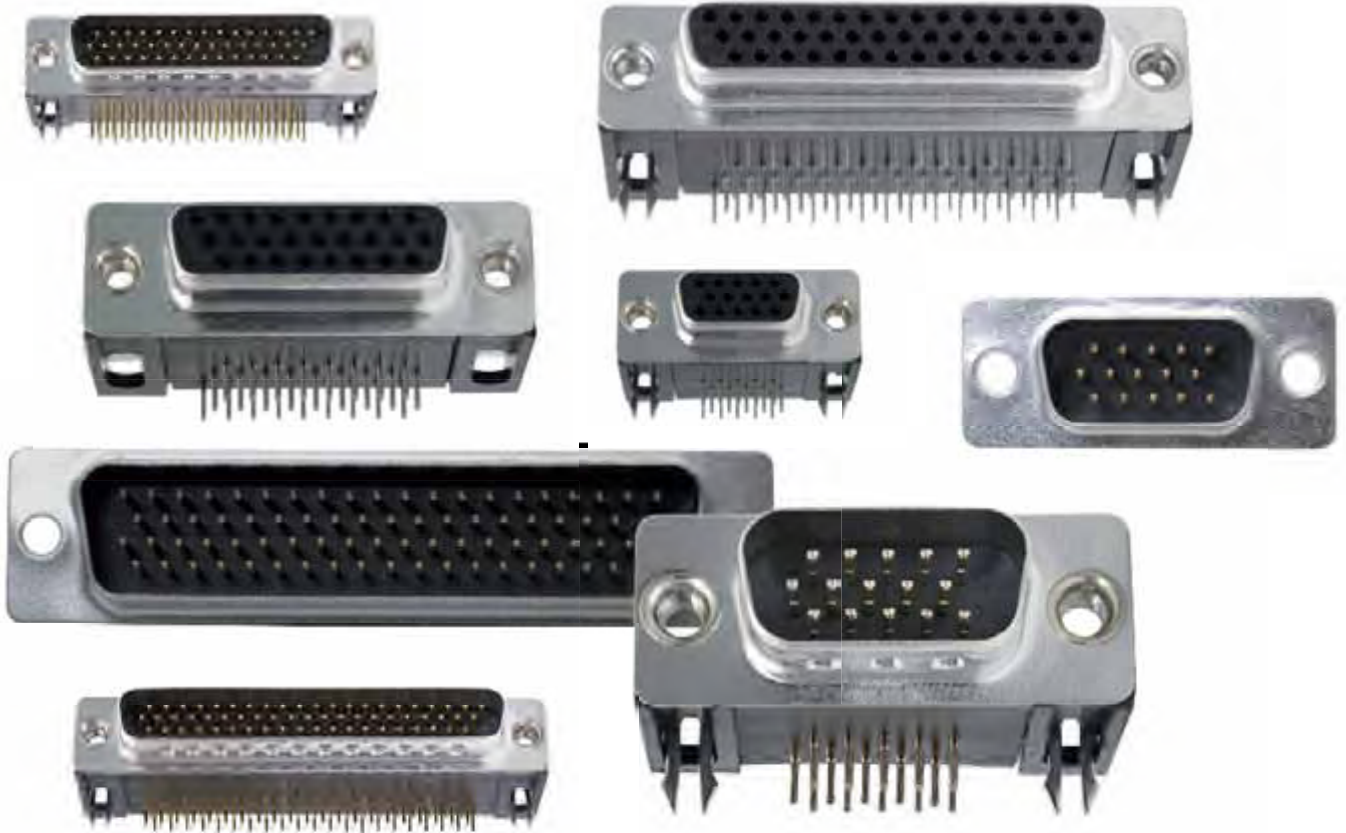

#### Advantages and Special Features

In terms of their outside dimensions the shells of the high density D-Sub series are the same as for the well known standard D-Sub connectors but the number of contacts has been considerably increased.

Due to the higher density of 15, 26, 44, 62 and 78 contacts, this series is ideally suited for the most modern applications in data transmission and telecommunications as well as in measurement regulation and control devices.

Protection against misalignment or bending of contacts is guaranteed by the use of a trapeze shaped metal shell. The tin plated shells also offer good shielding qualities and are mechanically stable. Because of their compact design and low mounting flange, these connectors can also be used without difficulty in the tried and tested 19"-modules.

These connectors are available in straight and right angled versions for PCBs. They can also be supplied for cable assemblies in solder or crimp version. The heat resistant plastics used in the production of the connectors meet UL94V-0 requirements.

#### Vorteile und Merkmale im Überblick

*Die High Density D-Sub Serie verwendet von den Außenabmessungen die Gehäuse der bekannten Standard D-Sub Steckverbinder, jedoch hat sich die Anzahl der Kontakte wesentlich erhöht.*

*Durch die höhere Dichte von 15, 26, 44, 62 und 78 Kontakten eignet sich diese Serie hervorragend für modernste Anwendungen der Datentechnik, Telekommunikation sowie Mess-, Regel- und Steuerungstechnik.*

*Ein sicherer Verdrehenschutz ist durch das trapezförmige Metallgehäuse gewährleistet. Die verzinnnten Gehäuse bieten gute Abschirmeigenschaften und sind mechanisch stabil. Aufgrund der kompakten Bauweise und des niedrigen Montageflansches sind diese Steckverbinder in den bewährten 19"-Einschüben problemlos einsetzbar.*

*Die Steckverbinder sind in gerader bzw. abgewinkelter Ausführung für Leiterplattenmontage sowie zur Kabelmontage in Löt- oder Crimptechnik lieferbar. Die verwendeten temperaturbeständigen Kunststoffe entsprechen den Anforderungen nach UL94V-0.*



**High Density Connectors**  
*High Density Steckverbinder*

**Product Description**  
*Produktbeschreibung*

**Pin: Solder Pot Termination**

**Stift: Löttopfanschluss**

**Dimensions**  
*Abmessungen*

**Pin Connector, Front View**  
*Stiftsteckverbinder, Frontansicht*

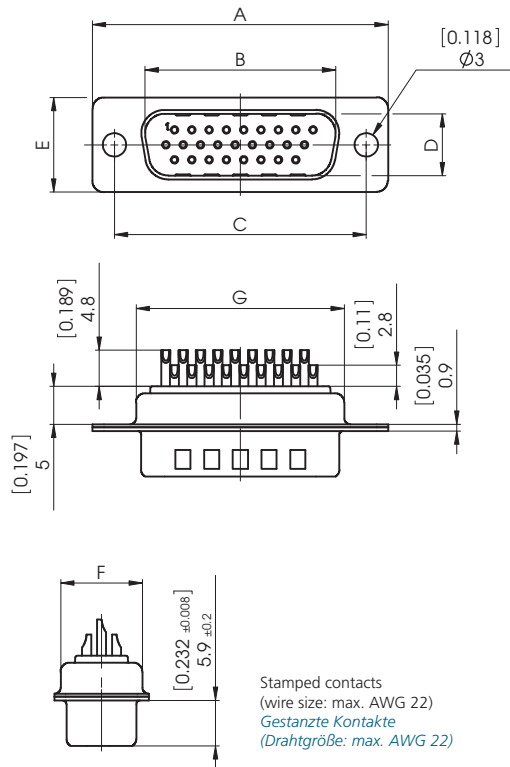

15 contacts  
*15 Kontakte*

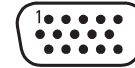

26 contacts  
*26 Kontakte*

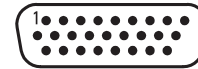

44 contacts  
*44 Kontakte*



62 contacts  
*62 Kontakte*



78 contacts  
*78 Kontakte*



Order Number <i>Bestellnummer</i>	Shell Size <i>Gehäusegröße</i>	Number of Contacts <i>Polzahl</i>	A ±0,4 (±0.016)	B +0,2 (+0.008)	C ±0,15 (±0.006)	D +0,2 (+0.008)	E ±0,4 (±0.016)	F ±0,3 (±0.012)	G ±0,3 (±0.012)
CT09-15P	1	15	30,8 (1.213)	16,9 (0.665)	25,0 (0.984)	8,2 (0.323)	12,5 (0.492)	10,8 (0.425)	19,3 (0.760)
CT15-26P	2	26	39,1 (1.539)	25,2 (0.992)	33,3 (1.311)	8,2 (0.323)	12,5 (0.492)	10,8 (0.425)	27,5 (1.083)
CT25-44P	3	44	53,0 (2.087)	38,9 (1.531)	47,0 (1.852)	8,2 (0.323)	12,5 (0.492)	10,8 (0.425)	41,3 (1.626)
CT37-62P	4	62	69,3 (2.728)	55,3 (2.177)	63,5 (2.500)	8,2 (0.323)	12,5 (0.492)	10,8 (0.425)	57,7 (2.272)
CT50-78P	5	78	66,9 (2.634)	52,8 (2.079)	61,1 (2.406)	11,0 (0.433)	15,4 (0.606)	13,7 (0.539)	55,3 (2.177)

Dimensions in mm (inch) - *Abmessungen in mm (inch)*

## High Density Connectors High Density Steckverbinder

## Product Description Produktbeschreibung

### Socket: Solder Pot Termination

### Buchse: Löttopfanschluss

#### Dimensions

#### Abmessungen

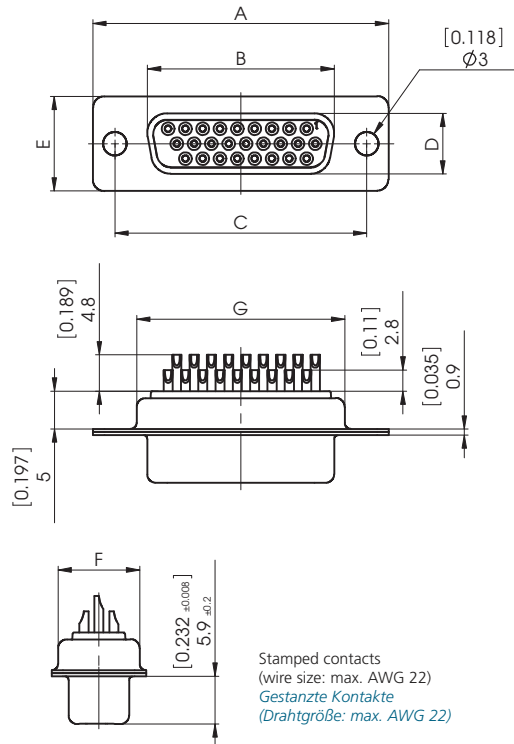

#### Socket Connector, Front View

#### Buchsensteckverbinder, Frontansicht

15 contacts  
15 Kontakte

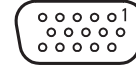

26 contacts  
26 Kontakte

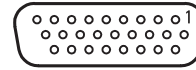

44 contacts  
44 Kontakte

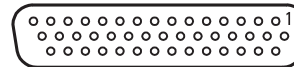

62 contacts  
62 Kontakte

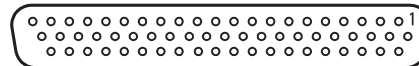

78 contacts  
78 Kontakte

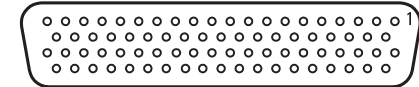

Order Number Bestellnummer	Shell Size Gehäusegröße	Number of Contacts Polzahl	A	B	C	D	E	F	G
			±0,4 (±0.016)	-0,2 (-0.008)	±0,15 (±0.006)	-0,2 (-0.008)	±0,4 (±0.016)	±0,3 (±0.012)	±0,3 (±0.012)
CT09-15S	1	15	30,8 (1.213)	16,4 (0.646)	25,0 (0.984)	8,0 (0.315)	12,5 (0.492)	10,8 (0.425)	19,3 (0.760)
CT15-26S	2	26	39,1 (1.539)	24,7 (0.972)	33,3 (1.311)	8,0 (0.315)	12,5 (0.492)	10,8 (0.425)	27,5 (1.083)
CT25-44S	3	44	53,0 (2.087)	38,5 (1.516)	47,0 (1.852)	8,0 (0.315)	12,5 (0.492)	10,8 (0.425)	41,3 (1.626)
CT37-62S	4	62	69,3 (2.728)	54,9 (2.161)	63,5 (2.500)	8,0 (0.315)	12,5 (0.492)	10,8 (0.425)	57,7 (2.272)
CT50-78S	5	78	66,9 (2.634)	52,5 (2.067)	61,1 (2.406)	10,8 (0.425)	15,4 (0.606)	13,7 (0.539)	55,3 (2.177)

Dimensions in mm (inch) - Abmessungen in mm (inch)



Pin: Straight PCB Termination

Stift: Gerader Leiterplattenanschluss

Dimensions  
Abmessungen

Pin Connector, Front View  
Stiftsteckverbinder, Frontansicht

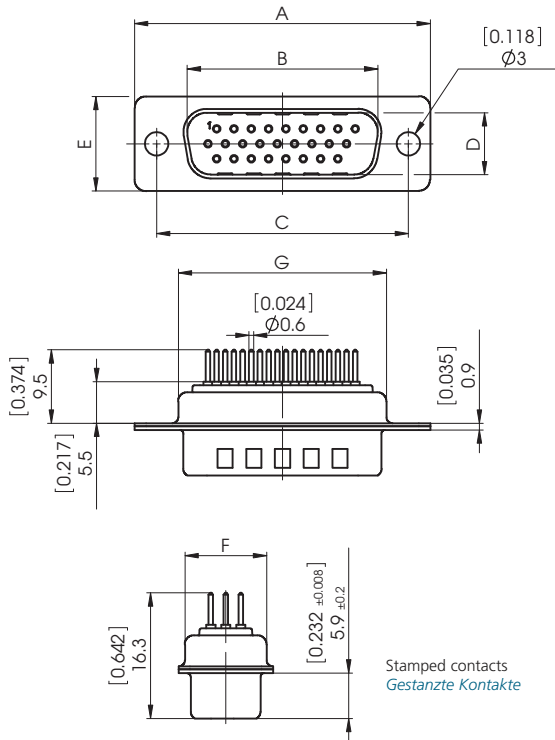

15 contacts  
15 Kontakte

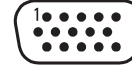

26 contacts  
26 Kontakte

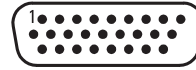

44 contacts  
44 Kontakte

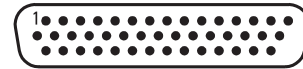

62 contacts  
62 Kontakte



78 contacts  
78 Kontakte



Order Number Bestellnummer	Shell Size Gehäusegröße	Number of Contacts Polzahl	A	B	C	D	E	F	G	H	J
			±0,4 (±0.016)	+0,2 (+0.008)	±0,15 (±0.006)	+0,2 (+0.008)	±0,4 (±0.016)	±0,3 (±0.012)	±0,3 (±0.012)		
CT09-15P1	1	15	30,8 (1.213)	16,9 (0.665)	25,0 (0.984)	8,2 (0.323)	12,5 (0.492)	10,8 (0.425)	19,3 (0.760)	7,10 (0.280)	2,29 (0.090)
CT15-26P1	2	26	39,1 (1.539)	25,2 (0.992)	33,3 (1.311)	8,2 (0.323)	12,5 (0.492)	10,8 (0.425)	27,5 (1.083)	6,80 (0.268)	2,29 (0.090)
CT25-44P1	3	44	53,0 (2.087)	38,9 (1.531)	47,0 (1.852)	8,2 (0.323)	12,5 (0.492)	10,8 (0.425)	41,3 (1.626)	7,00 (0.276)	2,29 (0.090)
CT37-62P1	4	62	69,3 (2.728)	55,3 (2.177)	63,5 (2.500)	8,2 (0.323)	12,5 (0.492)	10,8 (0.425)	57,7 (2.272)	7,00 (0.276)	2,42 (0.095)
CT50-78P1	5	78	66,9 (2.634)	52,8 (2.079)	61,1 (2.406)	11,0 (0.433)	15,4 (0.606)	13,7 (0.539)	55,3 (2.177)	7,60 (0.299)	2,42 (0.095)

Dimensions in mm (inch) - Abmessungen in mm (inch)

PCB Hole Pattern (Mounting Side)  
Leiterplattenlochbild (Bestückungsseite)

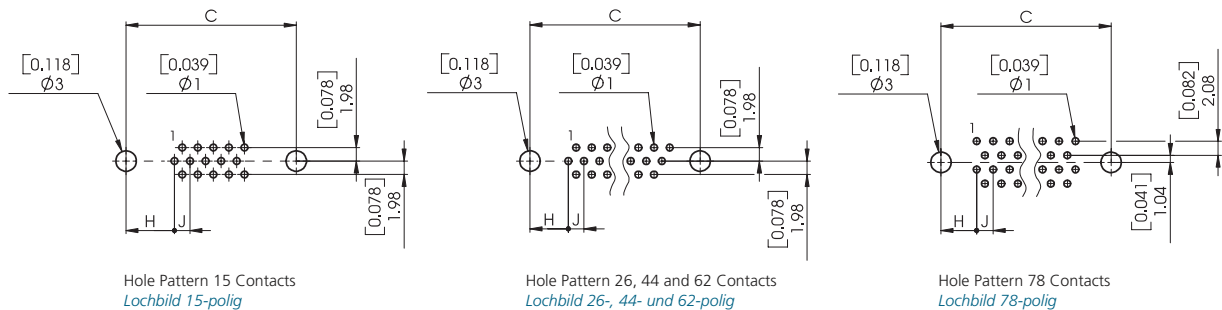



Pin: Right Angled PCB Termination

Stift: Abgewinkelter Leiterplattenanschluss

Dimensions

Pin Connector, Front View

Abmessungen

Stiftsteckverbinder, Frontansicht

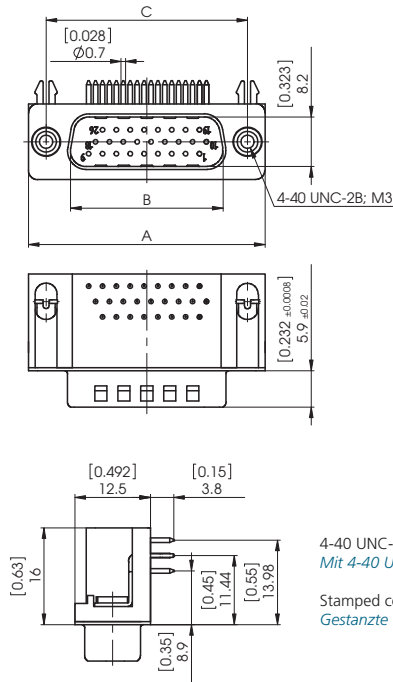

4-40 UNC-2B or M3 clinch nut on connector flange available.  
Mit 4-40 UNC-2B bzw. M3 Gewindenut im Steckerflansch lieferbar.

Stamped contacts  
Gestanzte Kontakte

15 contacts  
15 Kontakte

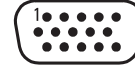

26 contacts  
26 Kontakte

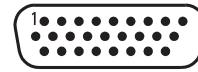

44 contacts  
44 Kontakte



62 contacts  
62 Kontakte



Order Number Bestellnummer	Shell Size Gehäusegröße	Number of Contacts Polzahl	A	B	C	H	J		
Grounding Brackets with Snap-in Snap-in Massewinkel	Grounding Brackets with Snap-in Snap-in Massewinkel	Grounding Brackets without Snap-in Massewinkel ohne Snap-in							
4-40 UNC-2B	M3	4-40 UNC-2B	$\pm 0,4$ ( $\pm 0.016$ )	$+0,2$ ( $+0.008$ )	$\pm 0,15$ ( $\pm 0.006$ )				
CT09-15P5-L228	CT09-15P5-L229	CT09-15P5-L222	1	15	30,8 (1.213)	16,9 (0.665)	25,0 (0.984)	7,10 (0.280)	2,29 (0.090)
CT15-26P5-L228	CT15-26P5-L229	CT15-26P5-L222	2	26	39,1 (1.539)	25,2 (0.992)	33,3 (1.311)	6,80 (0.268)	2,29 (0.090)
CT25-44P5-L228	CT25-44P5-L229	CT25-44P5-L222	3	44	53,0 (2.087)	38,9 (1.531)	47,0 (1.852)	7,00 (0.276)	2,29 (0.090)
CT37-62P5-L228	CT37-62P5-L229	CT37-62P5-L222	4	62	69,3 (2.728)	55,3 (2.177)	63,5 (2.500)	7,00 (0.276)	2,42 (0.095)

Dimensions in mm (inch) - Abmessungen in mm (inch)

PCB Hole Pattern (Mounting Side)

Leiterplattenlochbild (Bestückungsseite)

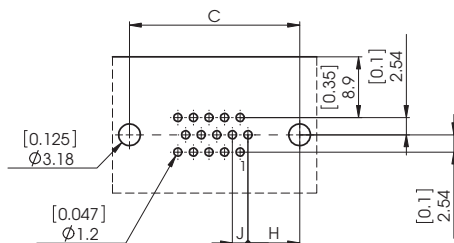

Hole Pattern 15 Contacts  
Lochbild 15-polig

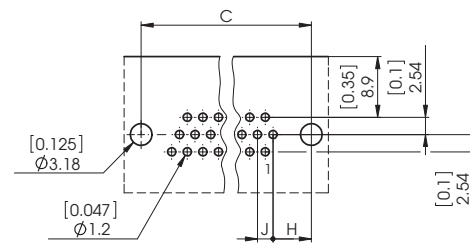

Hole Pattern 26, 44 and 62 Contacts  
Lochbild 26-, 44- und 62-polig

Socket: Right Angled PCB Termination

Buchse: Abgewinkelter Leiterplattenanschluss

Dimensions  
Abmessungen

Socket Connector, Front View  
Buchsensteckverbinder, Frontansicht

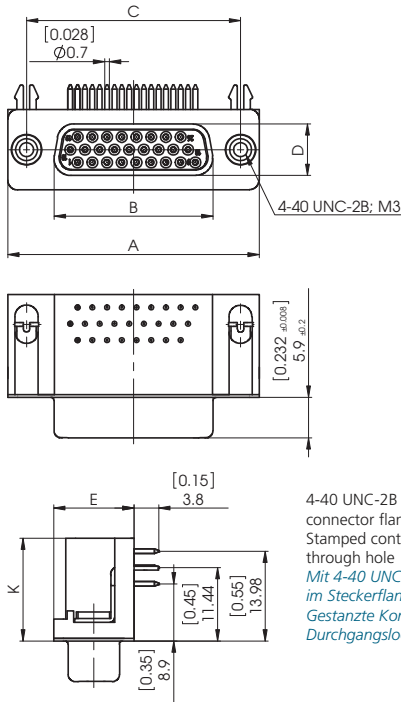

15 contacts  
15 Kontakte

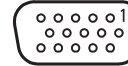

26 contacts  
26 Kontakte

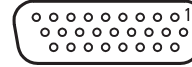

44 contacts  
44 Kontakte

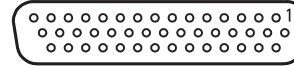

62 contacts  
62 Kontakte

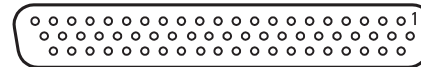

78 contacts  
78 Kontakte

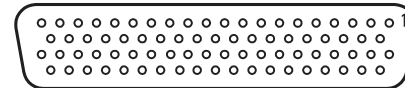

Order Number      Shell Size      No. of Contacts      A      B      C      E      H      J      K  
Bestellnummer      Gehäusegröße      Polzahl

Grounding Brackets with Snap-in <i>Snap-in Massewinkel</i>	Grounding Brackets with Snap-in <i>Snap-in Massewinkel</i>	Grounding Brackets without Snap-in <i>Massewinkel ohne Snap-in</i>			A	B	C	E	H	J	K
4-40 UNC-2B	M3	4-40 UNC-2B			±0,4 (±0.016)	-0,2 (-0.008)	±0,15 (±0.006)	±0,4 (±0.016)			
CT09-15S5-L228	CT09-15S5-L229	CT09-15S5-L222	1	15	30,8 (1.213)	16,4 (0.646)	25,0 (0.984)	12,5 (0.492)	7,10 (0.280)	2,29 (0.090)	16,0 (0.630)
CT15-26S5-L228	CT15-26S5-L229	CT15-26S5-L222	2	26	39,1 (1.539)	24,7 (0.972)	33,3 (1.311)	12,5 (0.492)	6,80 (0.268)	2,29 (0.090)	16,0 (0.630)
CT25-44S5-L228	CT25-44S5-L229	CT25-44S5-L222	3	44	53,0 (2.087)	38,5 (1.516)	47,0 (1.852)	12,5 (0.492)	7,00 (0.276)	2,29 (0.090)	16,0 (0.630)
CT37-62S5-L228	CT37-62S5-L229	CT37-62S5-L222	4	62	69,3 (2.728)	54,9 (2.161)	63,5 (2.500)	12,5 (0.492)	7,00 (0.276)	2,42 (0.095)	16,0 (0.630)
CT50-78S5-L228	CT50-78S5-L229*	—	5	78	66,9 (2.634)	52,5 (2.067)	61,1 (2.406)	13,8 (0.543)	7,60 (0.299)	2,42 (0.095)	17,4 (0.685)

\* On request / auf Anfrage      Dimensions in mm (inch) - Abmessungen in mm (inch)

PCB Hole Pattern (Mounting Side)  
Leiterplattenlochbild (Bestückungsseite)

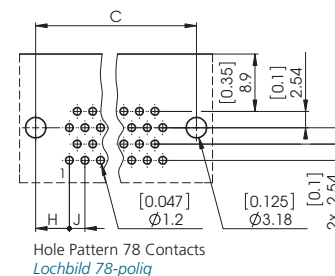
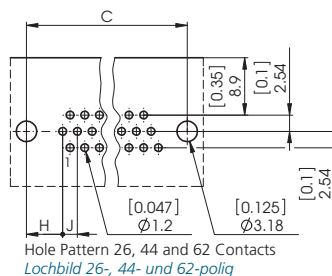
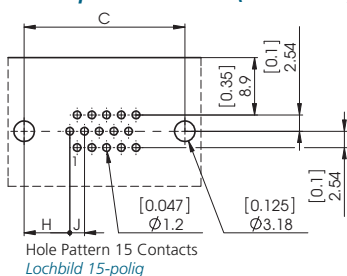





Mechanical Data

Mechanische Daten

Mechanical Data	
Mechanische Daten	
Shell	Steel, nickel plated; pin shell with dimples
Gehäuse	Stahl, vernickelt; Stiftgehäuse mit Kontaktnoppen
Insulator	Thermoplastic, glassfilled UL94V-0
Isolierkörper	Thermoplast, glasfaserverstärkt UL94V-0
Signal contacts	Copper alloy, flash gold plated
Signalkontakte	Kupferlegierung, Oberfläche Hauchvergoldung

Panel Cut-Out

Front Mounted  
Standard, Front Mounted  
Standard, frontseitig montiert

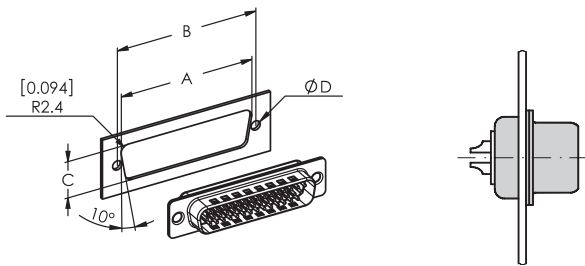

Shell Size	A	B	C
Gehäusegröße	±0,2 (±0.008)	±0,1 (±0.004)	±0,2 (±0.008)
1	22,2 (0.874)	25,0 (0.984)	12,3 (0.484)
2	30,5 (1.201)	33,3 (1.311)	12,3 (0.484)
3	44,3 (1.744)	47,0 (1.850)	12,3 (0.484)
4	60,7 (2.390)	63,5 (2.500)	12,3 (0.484)
5	58,3 (2.295)	61,1 (2.406)	15,1 (0.594)

Dimensions in mm (inch) - Abmessungen in mm (inch)

Rear Mounted  
Standard, Rear Mounted  
Standard, rückseitig montiert

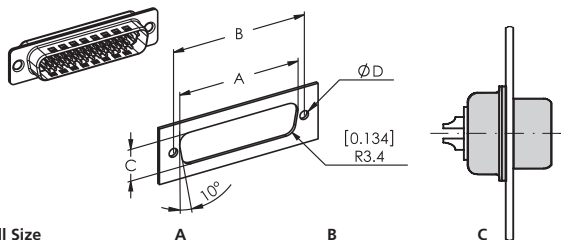

Shell Size	A	B	C
Gehäusegröße	±0,2 (±0.008)	±0,1 (±0.004)	±0,2 (±0.008)
1	20,5 (0.807)	25,0 (0.984)	11,4 (0.449)
2	28,8 (1.134)	33,3 (1.311)	11,4 (0.449)
3	42,5 (1.673)	47,0 (1.850)	11,4 (0.449)
4	59,1 (2.327)	63,5 (2.500)	11,4 (0.449)
5	56,3 (2.217)	61,1 (2.406)	14,1 (0.555)

Dimensions in mm (inch) - Abmessungen in mm (inch)

Electrical Data

Elektrische Daten

Electrical Data	
Elektrische Daten	
Current rating	3 A
Maximale Stromstärke	
Contact resistance	≤ 15 mΩ
Durchgangswiderstand	
Insulation resistance	≥ 3000 mΩ
Isolationswiderstand	
Test voltage	1000 V
Prüfspannung	
Operating temperature	-55 °C bis 105 °C (-67 °F to 221 °F)
Betriebstemperatur	

Montageausschnitt

Frontseitig montiert  
Float, Front Mounted (Series FW)  
Schwimmend, frontseitig montiert (Baureihe FW)

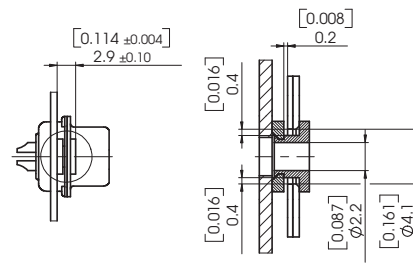

Shell Size	Mounting	Ø D
Gehäusegröße	Befestigung	±0,05 (±0.002)
1 - 5	Standard / Standard	3,1 (0.122)
1 - 5	Float mounted / schwimmend	2,2 (0.087)

Dimensions in mm (inch) - Abmessungen in mm (inch)

Rückseitig montiert  
Float, Rear Mounted (Series FW)  
Schwimmend, rückseitig montiert (Baureihe FW)

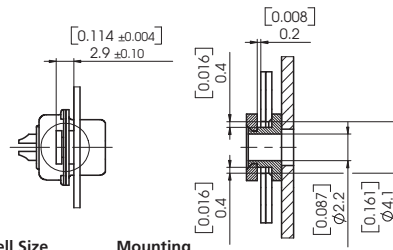

Shell Size	Mounting	Ø D
Gehäusegröße	Befestigung	±0,05 (±0.002)
1 - 5	Standard / Standard	3,1 (0.122)
1 - 5	float mounted / schwimmend	2,2 (0.087)

Dimensions in mm (inch) - Abmessungen in mm (inch)