

## DATA SHEET

## Cable Socket for SF 1/2"-50, Type 4.3-10 || BN 431112

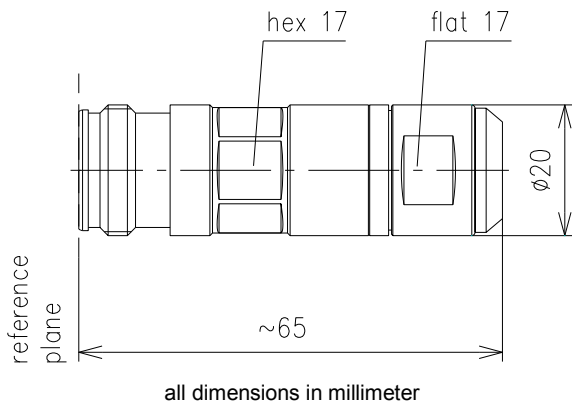

|   |  |  |
|---|--|--|
| Interface type                            | 4.3-10 socket MultiFit™ (50 Ω) per IEC61169-54   |  |
| VSWR, max.                                | 1.02 @ DC to 1 GHz<br>1.03 @ 1 to 2.7 GHz<br>1.08 @ 2.7 to 3.8 GHz<br>1.14 @ 3.8 to 6 GHz      |  |
| Frequency range                           | DC to 6 GHz  |  |
| Inner conductor material / surface finish | copper alloy / silver plated   |  |
| Outer conductor material / surface finish | copper alloy / CuSnZn plated<br>copper alloy / silver plated                                   |  |
| Other metal parts / surface finish        | copper alloy / bright nickel plated  |  |
| Insulation                                | PTFE   |  |
| Sealing                                   | silicone rubber silicone rubber  |  |
| Degree of protection                      | IP68 per EN 60529 (interface connected with appropriate gasket)                                |  |
| Cable compatibility                       | Spinner<br>Acome<br>Andrew<br>Draka<br>Eupen<br>Hansen<br>Hengxin<br>Leoni<br>LS Cables<br>RFS | SPINNERFlex™ SF1/2"-50<br>HPL50-1/2SF<br>FSJ4-50B<br>RFF 1/2"-50<br>EC4-50-HF<br>RF 50 1/2"S<br>HRCAY-50-9<br>FlexLine 1/2" S<br>HFSC 12D<br>SCF 12-50 |
| Installation instructions                 | M32106   |  |
| Weight, approx.                           | 85 g   |  |
| Included in delivery                      | installation instructions  |  |