

1	2	3	4	5	6	7	8
ISS ZONE		REVISIONS					
		DESCRIPTION\PER REQUEST\DATE					

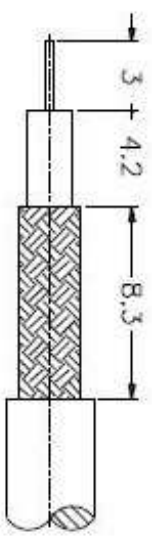

RECOMMENDED
CABLE STRIPPING DIM'S

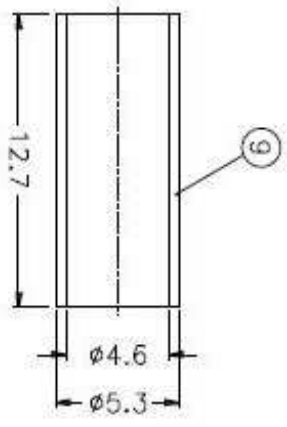
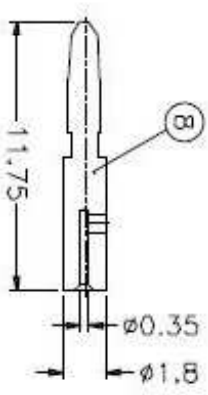
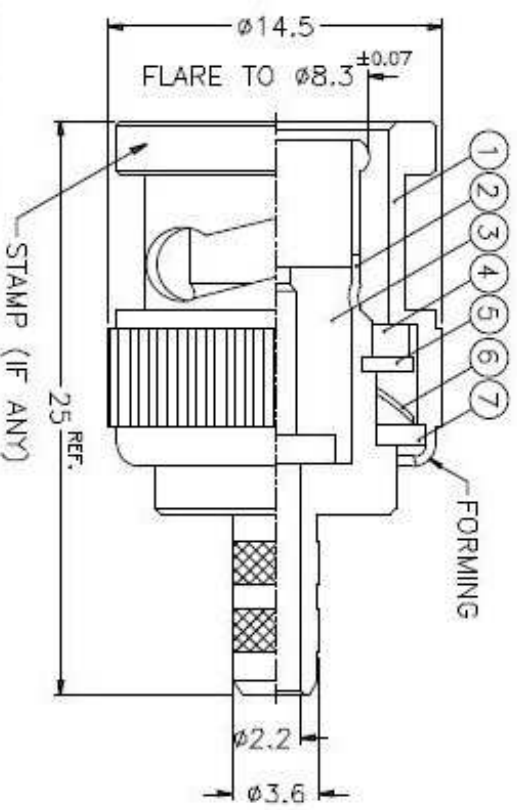

- NOTES: FINISH (PLATING THICKNESS IN MICRO-INCHES)
1. BRASS PER QQ-B-696
 2. BRASS PER QQ-B-613
 3. NICKEL PL. 100 MIN. THICK OVER COPPER STRIKE
 4. NICKEL PL. 200 MIN. THICK OVER COPPER STRIKE
 5. GOLD PL. 3 MIN. THICK OVER NICKEL PL. 100 MIN. THICK OVER COPPER STRIKE
 6. PTFE MIL-P-19468

1. CRIMPED FERRULE
HEX CRIMP SIZE .18"
2. CRIMPED CONTACT PIN
HEX CRIMP SIZE .055"/.06"

9	FERRULE	COPPER	NOTE 3	1	FR-53/46X127C
8	CONTACT PIN	NOTE 1	NOTE 5	1	B1121A9-003-B
7	WASHER	NOTE 2	NOTE 3	1	WS-128/9X08
6	SPRING	SK5	NOTE 4	1	B50000-6
5	RETAINER RING	NOTE 1	NOTE 3	1	B50000-5
4	GASKET	RUBBER	RED	1	GS-115/8X15
3	INSULATOR	NOTE 6	NATURAL	1	B1121A9-003-3T
2	BODY	NOTE 1	NOTE 3	1	B50000-2-36/22
1	SHELL	NOTE 1	NOTE 3	1	B50000-1-B
NO.	DESCRIPTION	MATERIAL	FINISH	QTY	DRAWING NO.

DIMENSIONS ARE IN MILLIMETERS
UNLESS OTHERWISE SPECIFIED
TOLERANCES

0.5-6	±0.2
6-30	±0.4
30-120	±0.6
120-515	±1
315-1000	±1.6
1000-2000	±2.4

PART NO.	DATE
APPROVED	10-11-01*
CHECKED	DATE
DRAWN	10-11-01*

TITLE BNC CRIMP PLUG
(FOR BT3002 CABLE)

Amphenol

SCALE	3/1	ISSUE	A
FILE NO.			
DRAWING NO.			
ITEM NO.			