

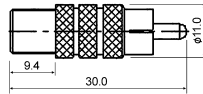

PLU010325

F FEMALE TO RCA PLUG



F MALE TO F FEMALE

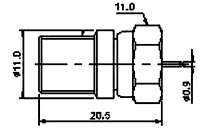

F FEMALE TO RCA JACK

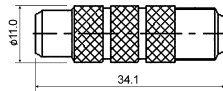
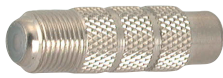

RIGHT ANGLE F MALE TO F FEMALE

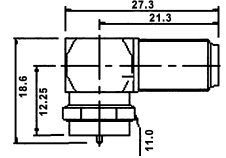

F QUICK CONNECTOR TWIST ON TYPE (RG58U/59U)

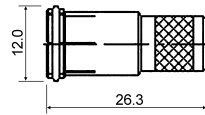

RIGHT ANGLE F FEMALE TO F MALE QUICK TYPE

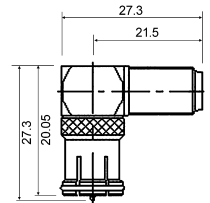

F MALE TWIST ON TYPE (RG213U)

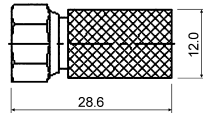

TRIPLE F FEMALE

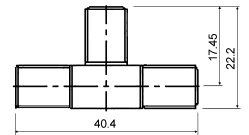
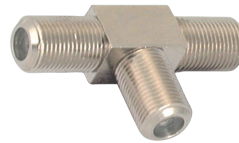

F QUICK CONNECTOR TWIST ON TYPE (RG58U/59U)

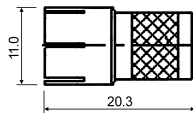

F FEMALE (RG59U/5C2V)

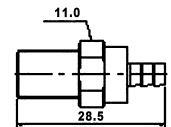

F MALE DUMMY LOAD 75 Ω TERMINATOR

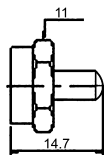

F QUICK MALE (RG59U)

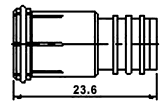

F FEMALE PCB MOUNT

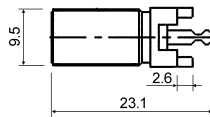

F FEMALE PCB MOUNT

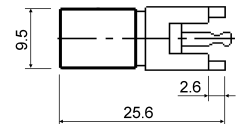

F FEMALE BULKHEAD

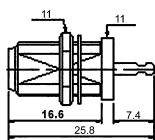

RIGHT ANGLE F FEMALE PCB MOUNT

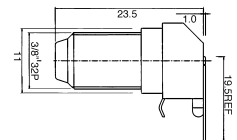

F FEMALE

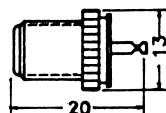

RIGHT ANGLE F FEMALE PCB MOUNT

