

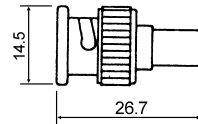

**BNC MALE TERMINATOR**

A : 50  
B : 75 Ω  
C : 93



**BNC MALE CRIMP TYPE (RG58U/59U)**

**M5569T**  
TEFLON INSULATION

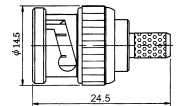

**BNC MALE CHASSIS MOUNT**

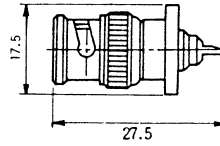
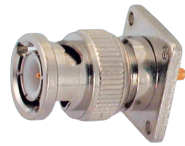

**BNC FEMALE PCB MOUNT**  
TEFLON INSULATION

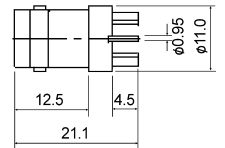

**BNC FEMALE TWIST ON TYPE (RG58U/59U)**

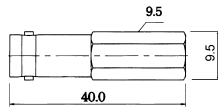

**BNC FEMALE PCB MOUNT**

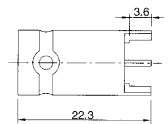

**BNC FEMALE BULKHEAD CRIMP TYPE**  
(RG58U/59U)

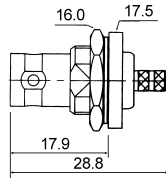
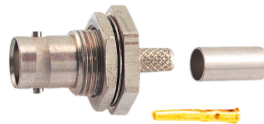

**BNC FEMALE TO F QUICK CONNECTOR**

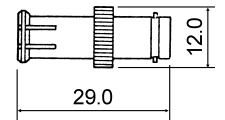

**RIGHT ANGLE BNC FEMALE CHASSIS PCB MOUNT**

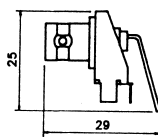

**BNC FEMALE TO 3.5mm PLUG**

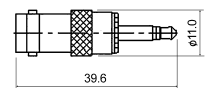

**DOUBLE BNC FEMALE BULKHEAD**

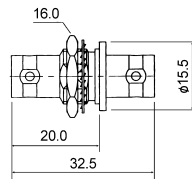

**BNC FEMALE TO PAL MALE**

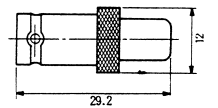

**BNC FEMALE BULKHEAD**

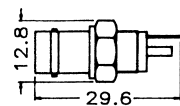

**BNC MALE CLAMP TYPE (RG58U/59U)**

TEFLON INSULATION

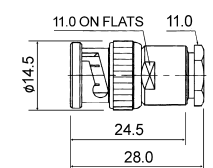
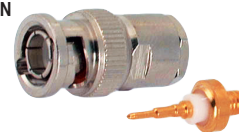

**BNC MALE BULKHEAD**

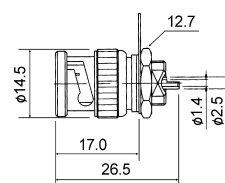

**BNC MALE CLAMP TYPE (RG8AU)**

TEFLON INSULATION

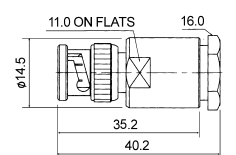

**PLU010094**

**BNC FEMALE CRIMP TYPE (RG58U/59U)**

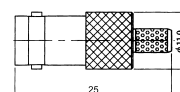

**RIGHT ANGLE BNC MALE TO UHF FEMALE**

